

**SNOW PILES PUSHED ACROSS THE ROAD WILL FREEZE UP. WHEN HIT, THEY JOLT THE DRIVER AND CAN DAMAGE THE PLOW TRUCK.**

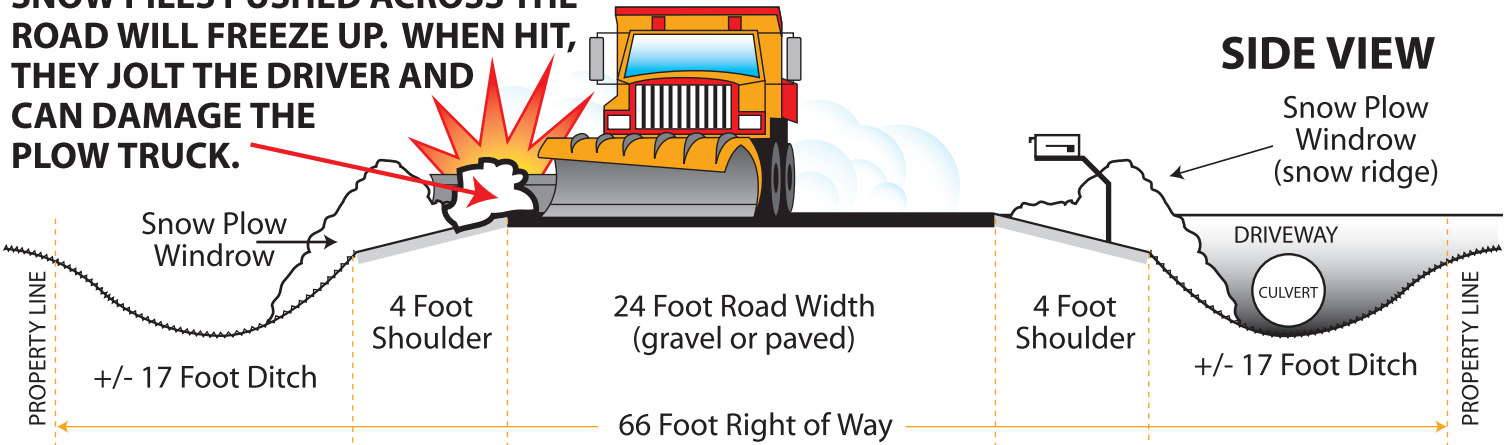

**TOP VIEW**

**DON'T DO THIS**

**TOP VIEW**

Snow Plow Windrow (snow ridge)

**IT IS AGAINST THE LAW IN MINNESOTA TO PUSH SNOW ACROSS THE ROAD.**

Minnesota Statute 160.2715

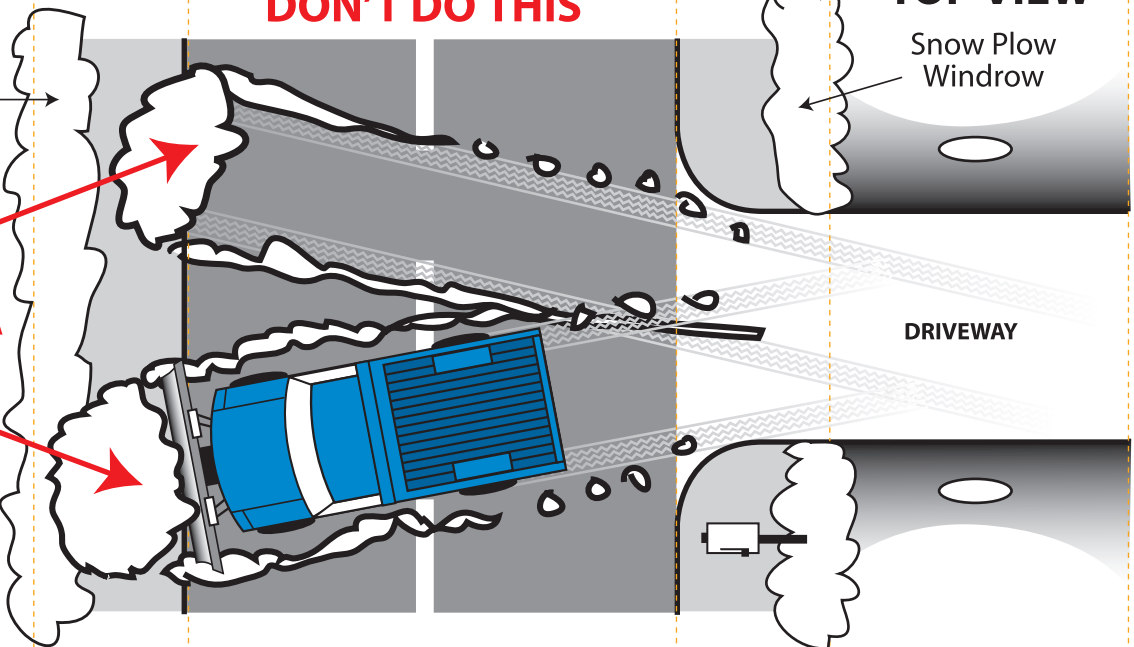

**CORRECT METHOD**

Snow Plow Windrow (snow ridge)

**PUSH THE SNOW INTO YOUR OWN PROPERTY, EVEN WITH OR PAST THE SNOW PLOW WINDROW.**

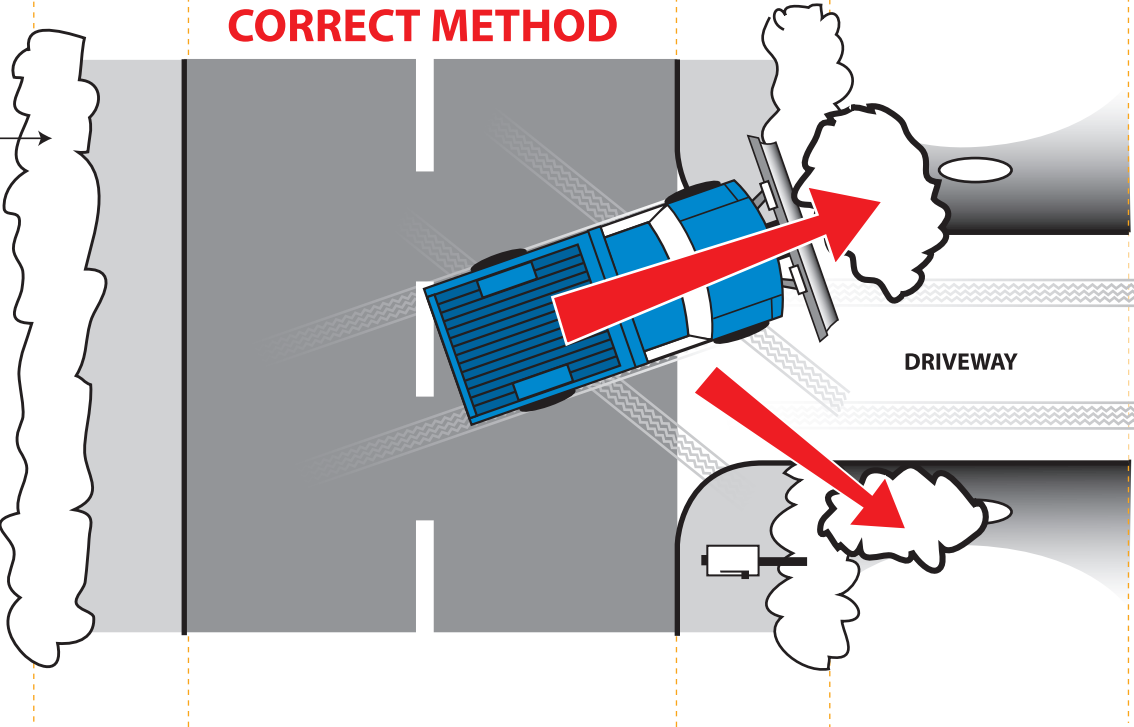

## SNOWPLOWING POLICY



The criteria for the decision on when the snow is plowed is:

- ◆ Snow accumulation of two (2) inches or more
- ◆ Drifting of snow that causes problems for travel
- ◆ Icy conditions which seriously affect travel
- ◆ Time of snowfall in relationship to heavy use of streets

Snow and ice control operations are expensive and involve the use of limited personnel and equipment. Consequently, snowplowing operations will not generally be conducted for snowfall of less than two (2) inches.

Snow will be plowed in a manner so as to minimize traffic obstructions. The center of the roadway will be plowed first. The snow shall then be pushed from left to right on two-way streets. The discharge shall go onto the road right-of-way area of the street.

Damage to a mailbox is a risk that snowplow operators face during their winter plowing requirements. The City will conduct a review of each mailbox damage claim to determine whether the City has any legal responsibility for the damage; and if so, to replace or provide reimbursement for the mailbox. If the City, in its discretion, determines that reimbursement or replacement is appropriate, the City may:

- ◆ At the mailbox owner's request, replace the mailbox with a standard size, non-decorative metal mailbox and replace the support post with a metal swing away post. Both will be installed by the City.
- ◆ Provide reimbursement, in a reasonable amount, for the mailbox and support posts that meet the City's Ordinance standards, as well as state and federal requirements for mailbox size, support and placement.

**THE CITY IS NOT RESPONSIBLE** for irrigation systems, garbage cans or fences, unless they are hit by City equipment; and only then if they have been properly located (outside of the Right-Of-Way).

ROCKS or POSTS that are in the Right-of-Way need to be removed before any snowfall to prevent plow damage. Rocks along driveways must be lower than the road.

## WINTER PARKING REGULATIONS:

IT SHALL BE UNLAWFUL for any person to park a motor vehicle, trailer, mobile home or accessory unit on a public street from the **15th of November to the 1st day of April between the hours of 11:00 PM to 7:00 AM.**

IT SHALL BE UNLAWFUL for any person to park on any public streets, ditches and rights-of-way within the City **anytime at which more than two (2) inches of fresh snow has accumulated** until such time as the snow removal crew have cleared the roadway.

IT SHALL BE UNLAWFUL for any person to park a motor vehicle, trailer, mobile home or accessory unit on a public street for **more than a 24 hour consecutive period.**

*The Anoka County Sheriff's Department and other authorized representatives of the City are hereby authorized to remove any offending vehicle from a City road. Vehicles will be towed and stored at Owner's own expense.*